

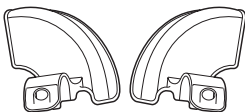

INSTRUCTIONS

IMPORTANT:
Read these instructions carefully before use and keep them for future reference.
Your child's safety may be affected if you do not follow these instructions.

PARTS

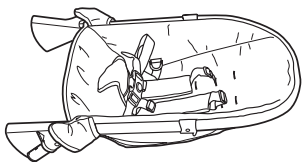
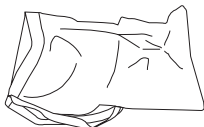
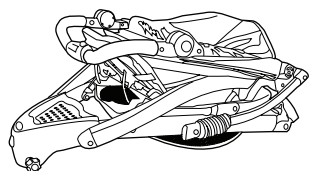
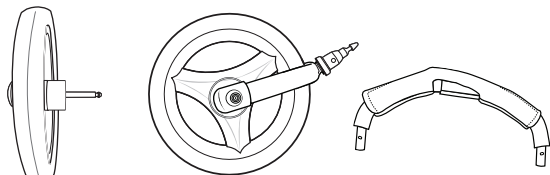

ACCESSORIES

(certain models only)

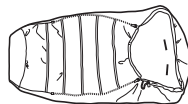
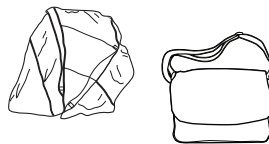

Opening Pushchair

1

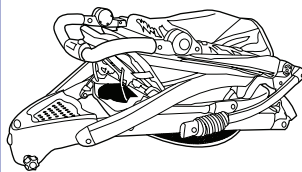

2

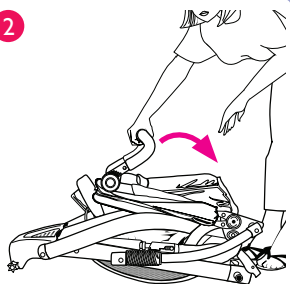

3

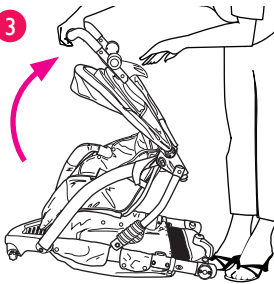

4

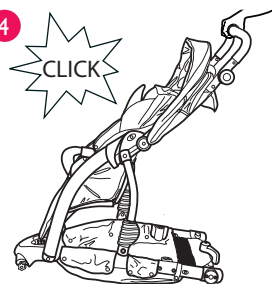

Attach Rear Fenders

5

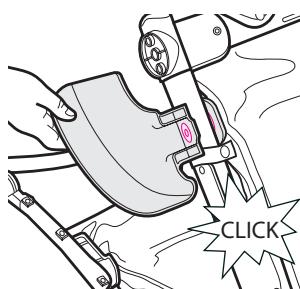
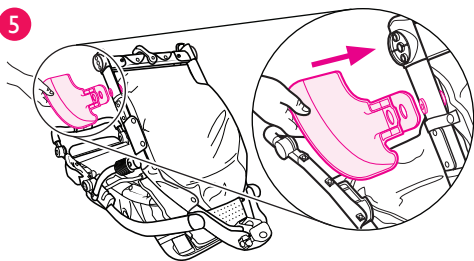

Rear Wheels

6

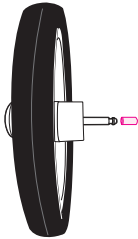

7

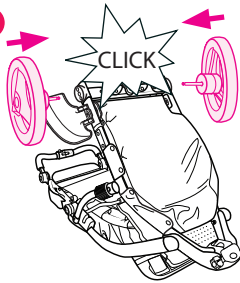

Front Wheel

8

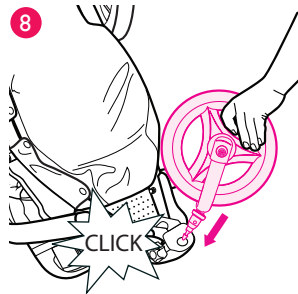

To Attach Bumper

9

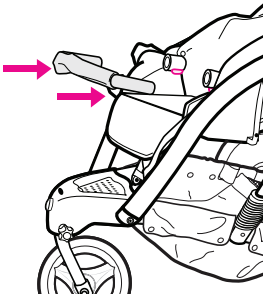

10

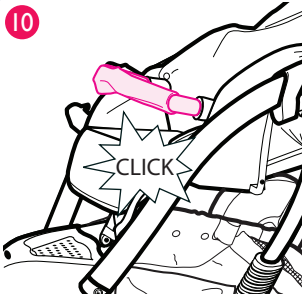

Rumble Seat

11

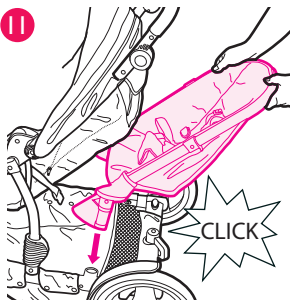

To Recline

12

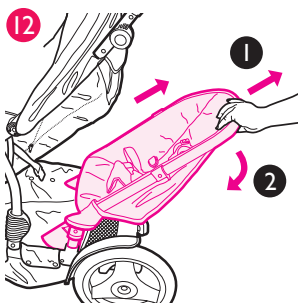

To Remove

13

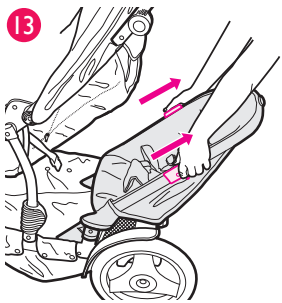

Securing Child

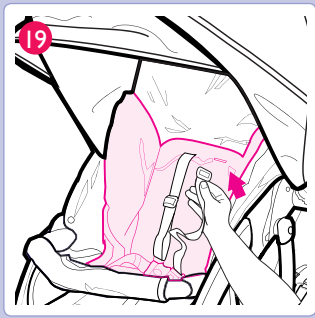
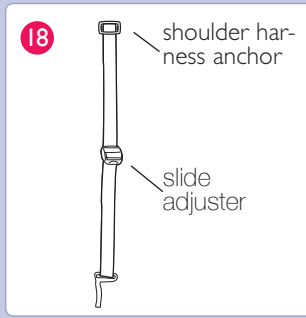
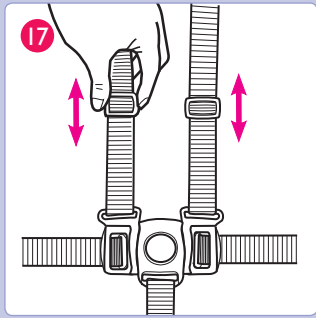
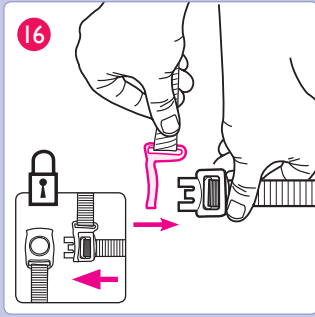
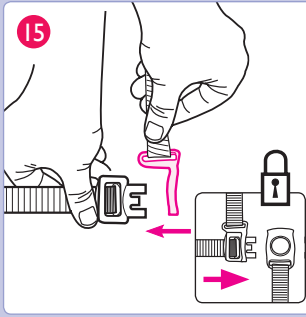
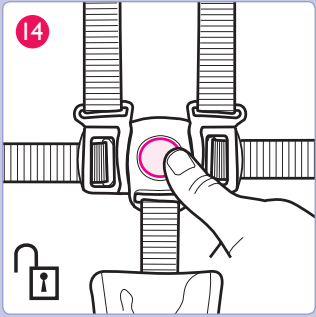

To adjust canopy

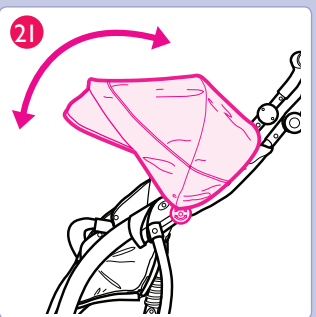
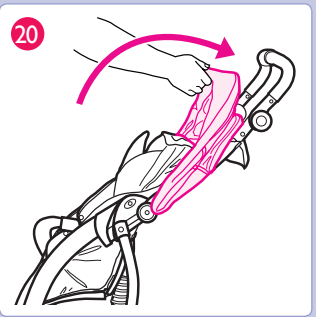

To adjust backrest

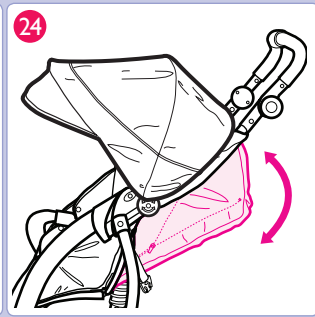
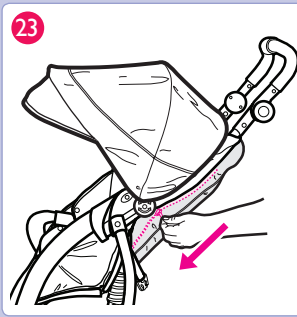
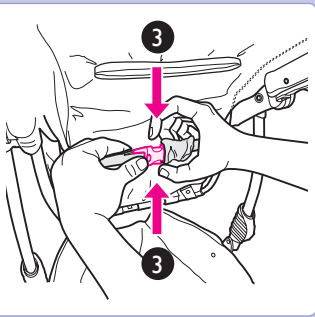
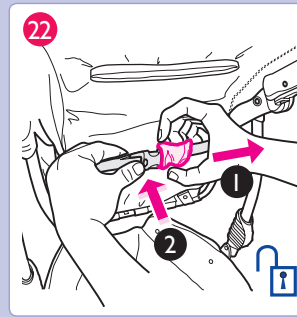

Brakes

25

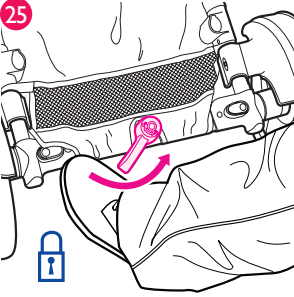

26

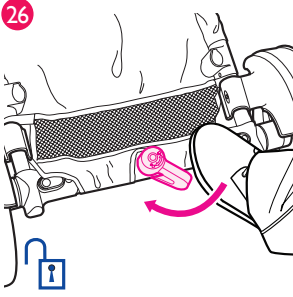

To adjust footrest

27

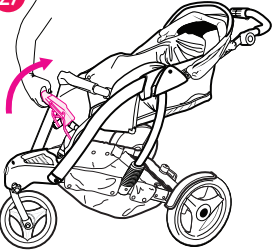

28

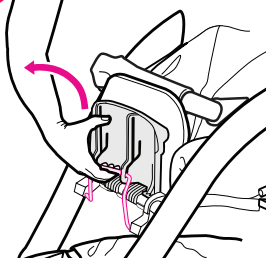

29

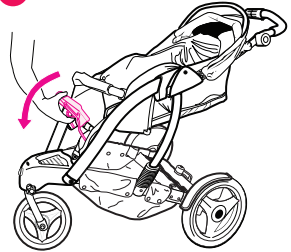

Attaching car seat (Sold Separately)

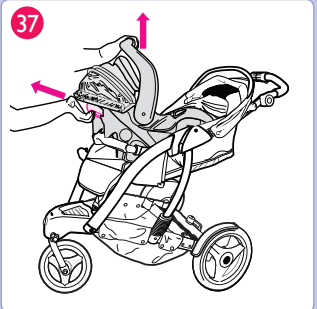
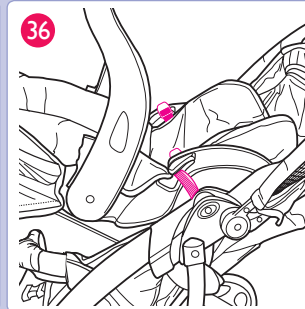
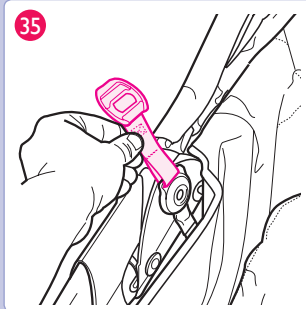
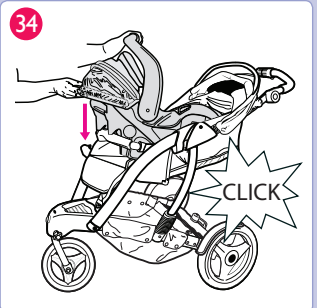
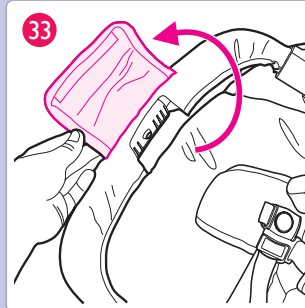
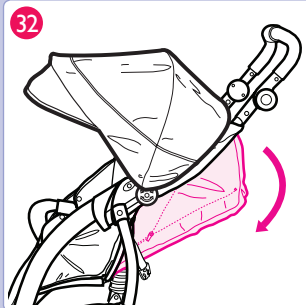
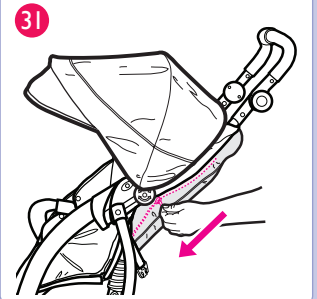
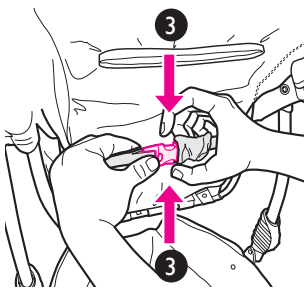
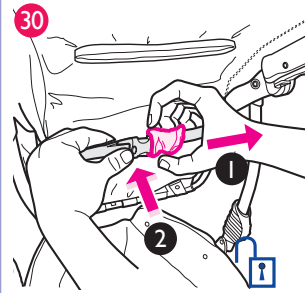

To fold

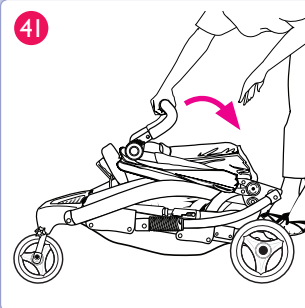
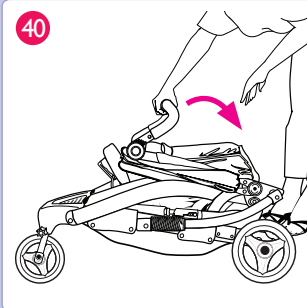
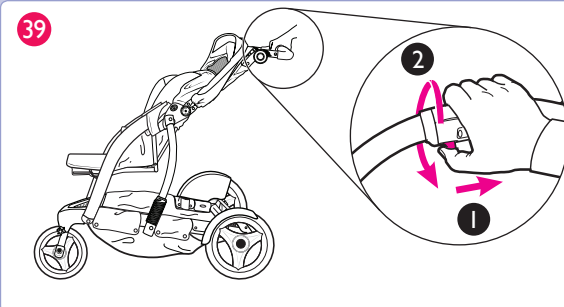
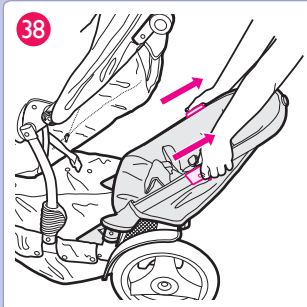

To Remove Wheels

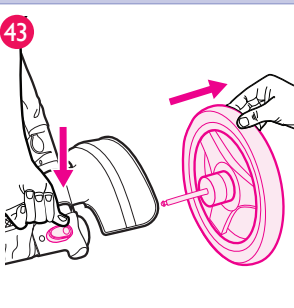
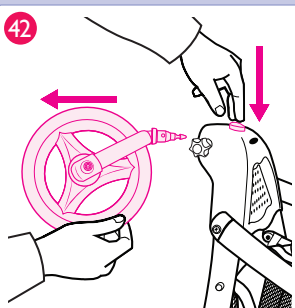

Swivel Wheels

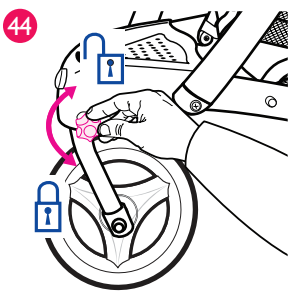

Rain Cover

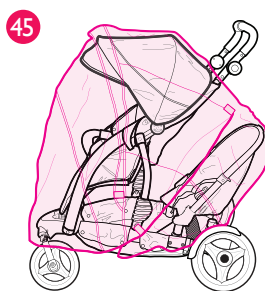

Pushchair Sleeping Bag

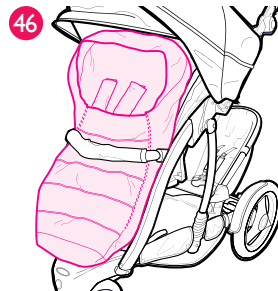

GB

IMPORTANT: READ THESE INSTRUCTIONS CAREFULLY BEFORE USE AND KEEP THEM FOR FUTURE REFERENCE. YOUR CHILD'S SAFETY MAY BE AFFECTED IF YOU DO NOT FOLLOW THESE INSTRUCTIONS.

WARNING: Remember a child's safety is your responsibility.

WARNING: Never leave your child unattended.

Children should be harnessed in at all times and should never be left unattended.

The child should be clear of all moving parts while making adjustments.

This vehicle requires regular maintenance by the user.

Overloading, incorrect folding and the use of non-approved accessories may damage or break this vehicle. Read the instructions.

Do not hang shopping bags from the handle or carry shopping bags on the pushchair except in a Graco-approved shopping tray. Maximum load 5 kg. **NEVER ON THE FOOTREST.**

It may be unsafe to use accessories e.g. child seats, bag hooks, rain covers, etc. other than those approved by the manufacturer.

It may be unsafe to use replacement parts other than those approved by the manufacturer.

Use of this pushchair with a child weighing more than 30 kg will cause excessive wear and stress on this pushchair.

This vehicle should only be used for a maximum of two children.

This vehicle is intended for one child from 0 months and up to 15kg in the front seat and one child from 6 months up to 15kg in the rear/rumble seat.

WARNING: The rear/rumble seat is not suitable for children under 6 months.

WARNING: The pushchair is designed to be used from birth in the front seat in the most reclined position for newborn babies.

WARNING: Always use the restraint system.

WARNING: Do not let your child play with this product.

WARNING: To avoid injury ensure that your child is kept away when unfolding and folding this product.

WARNING: This product is not suitable for running or skating.

WARNING: Ensure that all the locking devices are engaged before use.

Always engaged parking device during loading and unloading of children.

WARNING Check that the pram body or seat unit or car seat attachment devices are correctly engaged before use.

WARNING: Use a harness as soon as your child can sit unaided.

WARNING: Always use the crotch strap in combination with the waist belt.

WARNING: Any load attached to the handle affects the stability of the pram/pushchair.

WARNING: Regularly lubricate all moving parts sparingly with a light general purpose machine oil, making sure that the oil penetrates between the components where these move against each other in use.

Only the Graco Junior Baby, SnugSafe and Logico S car seats are compatible with this pushchair.

Check the various safety devices and use them correctly.

Keep your child away from the folded free-standing unit so that it does not fall and injure your child.

Pushchairs should be serviced after an extended period of no use.

If your pushchair is used by anyone unfamiliar with it, e.g. grandparents, always show them how it works. D rings are provided at the ends of the waist belts on either side of the seat for the attachment of a safety harness approved to BS 6684 or EN13210.

Do not use a PVC rain hood indoors, in a hot atmosphere or near a direct heat source - baby may overheat.

Do not let go of your pushchair when close to moving road vehicles or trains, even with the brake on, the draught from the vehicle or train may move a free standing pushchair.

When ascending or descending stairs or escalators, always remove your child and fold the pushchair.

Avoid strangulation. **DO NOT** suspend strings from your pushchair or place items with strings on your child.

Please fully remove raincover before folding the pushchair.

CARE AND MAINTENANCE

REMOVABLE SEAT PAD may be machine washed in cold water on delicate cycle and drip-dried.

WHEN USING YOUR PUSHCHAIR at the beach, completely clean your pushchair afterwards to remove sand and salt from the wheel assemblies.

FROM TIME TO TIME CHECK YOUR PUSHCHAIR for loose screws, worn parts, torn material or stitching. Replace or repair the parts as needed.

DISCONTINUE USING YOUR PUSHCHAIR should it become damaged or broken.

TO CLEAN PUSHCHAIR FRAME, use only household soap or detergent and warm water. NO BLEACH, SPIRIT OR ABRASIVE CLEANERS. Allow to dry before storing.

EXCESSIVE EXPOSURE TO THE SUN could cause premature fading of pushchair plastic and fabric.

NOTES:



UK & IRELAND
Graco Children's Product
Halifax Avenue
Fradley Park
Lichfield WS13 8SS
United Kingdom

GRACO CONTINENTAL
EUROPE
Newell Rubbermaid
France SAS
18 Avenue Du Guimand
26120 Malissard
France

NEWELL RUBBERMAID
EUROPE SARL
Chemin de Blandonnet 10
CH-1214 Vernier/Geneva
Switzerland

www.gracobaby.eu