



For any enquires write to [consumer@baciuzzi.com](mailto:consumer@baciuzzi.com)  
For other supports, spare parts, and separate service please refer to  
the web site [www.baciuzzi.com](http://www.baciuzzi.com)

Baciuzzi reserves the right to make any necessary changes to the  
products at any time without notice. Assembled in P.R.C.

INSTRUCTION MANUAL



BX

Congratulations on your purchase of the BX Stroller. This product has been designed and developed with Technologies and high fashion in mind. Please take the time to read this manual carefully before using this product and keep it in a safe place for future reference. If you want to know more about Baciuzzi, please login on our website: [www.baciuzzi.com](http://www.baciuzzi.com) we would make full efforts to offer you the best service.

-----

## Contents

Product introductions .....	5-6
Assembling/Operating instructions .....	7-12
How to care for your stroller .....	13
Warranty terms and conditions .....	14-15

## **WARNING!**

- Important - Keep these instructions for future reference. Your child's safety may be affected if you do not follow these instruction.
- The stroller reclining seat is suitable for child from 0 to 36 months when it is adjusted to the lowest position, it is unsuitable for the child under 6 months on other positions!
- The weight of the child using the stroller should not exceed 15kgs !
- To avoid serious injury, always use the harness provided to secure your child !
- Never leave your child unattended!
- Ensure that all the locking devices are engaged before use.
- Always use the restraint system.
- This product is not suitable for running or skating.
- The parking device shall be engaged when placing and removing the children.
- To avoid injury ensure that your child is kept away when unfolding and folding this product.
- Do not let your child play with this product.
- Check that the pram body or seat unit or car seat attachment devices are correctly engaged before use.
- Only replacement parts supplied or recommended by the manufacturer/ distributor shall be used.
- Do not use accessories other than those supplied and approved by manufacturer!
- Do not hang bags or goods from the handle as this may cause the stroller to become unstable!
- Keep away from fire!
- Do not place additional mattress of thickness exceed 10mm inside the seat!
- This stroller is designed for one child only!

- Do not use the stroller on stairs or escalators when child is in it!
- Do not release locking devices to avoid mistake folding when child is in it!
- Do not lift the stroller by the bumper bar or tray(if supplied) !
- Promptly stop using the stroller when the parts are broken or worn out!
- Do not place more than 3kgs (6. 61 b) in the basket!
- To avoid the risk of suffocation,keep all plastic materials out of reach of children!
- A pocket on the rear canopy is approved for the carriage of 0.2kg (0.441 b)goods evenly distributed!
- Do not allow child to stand on the stroller!
- Do not use stroller when go down stairs!
- Color and features of product may differ from the diagrams shown!

## PRODUCTION SPECIFICATION

Model No.:BX

Product Standard N.:EN1888:2012 / GB14748-2006

- Main materials: aluminum tube, metal, plastic and fabric.
  - Removable front bumper enables you to lift your baby up from the stroller much more easily.
  - 5-point harness makes your baby much safer.
  - Suspension front and back wheels make your baby much more comfortable.
  - Adjustable Footrest to offer baby more comfortable
  - Adjustable Backrest to offer baby more comfortable
  - One-hand folding with second lock system, easy folding and satisfies.
  - Folded to be small and it can stand.
  - Super large basket.
- 
- Unfolding size:98.1x81.6x47CM
  - Package size:41.5x26x76.5CM
  - N.W.:4.5KG

## PART LIST

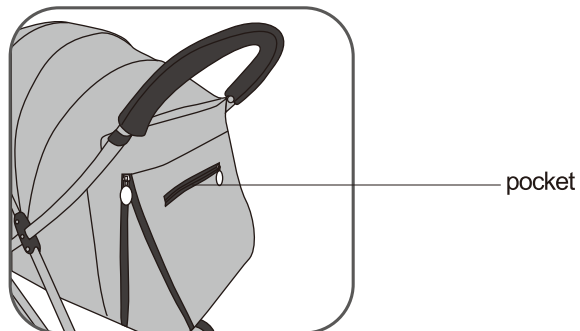
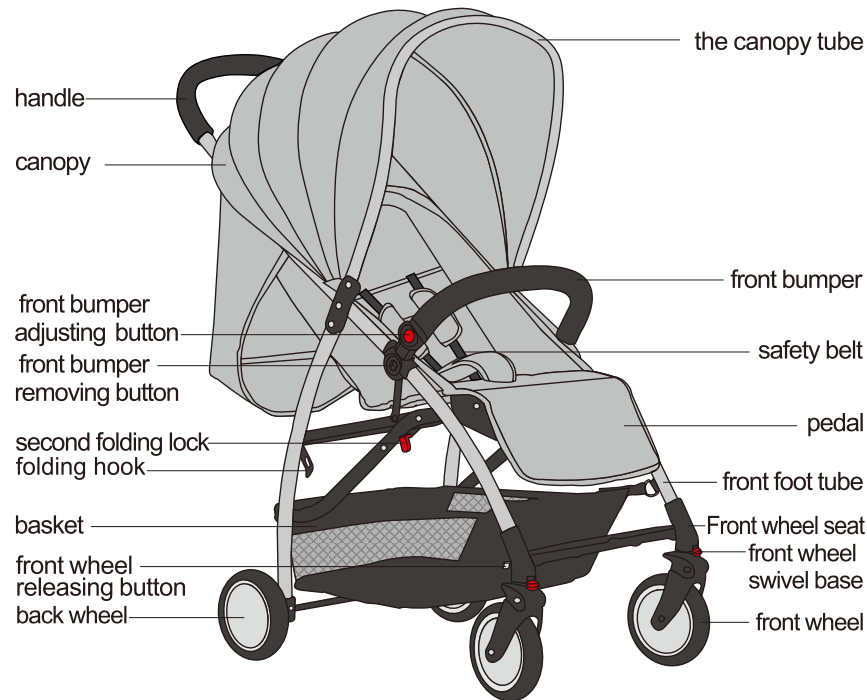

## ASSEMBLING/OPERATING INSTRUCTIONS

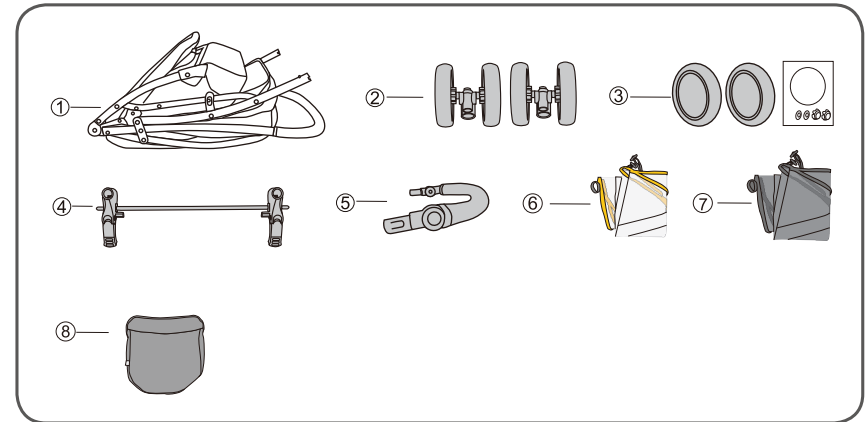

- Standard parts:
- ① Frame 1PC
  - ② Front wheel 2PCS and the parts for the front wheel
  - ③ Rear wheel 2PCS
  - ④ Back wheel holding assembly
  - ⑤ Front bumper 1PC
  - ⑥ Rain cover 1PC
  - ⑦ Mosquito net 1PC
  - ⑧ Foot cover 1PC

NOTE: Open carton and poly bag, take out all parts (please put the poly bag away in time).

### UNFOLDING THE STROLLER

Unfasten folding hook (figure 1) and lift the handlebar (figure 2). (picture A); Then push it upward; The handlebar will lock into place with "click". The frame will unfold itself. (picture B)

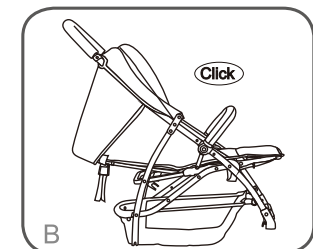
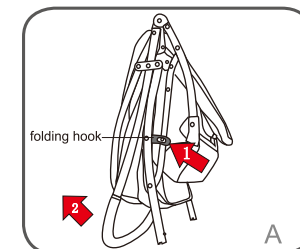

### MOUNTING THE FRONT WHEELS

Squeeze the assembling front wheel while inserting it into the front wheel housing, push it until you hear a "click". Pull to confirm it is assembled securely.

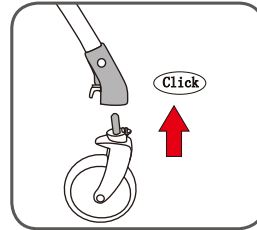

### SWIVEL WHEEL OPERATION

Lock the swivel wheel when using the stroller in a straight direction for a long period.

To lock, turn the button up.

To unlock, turn the button down.

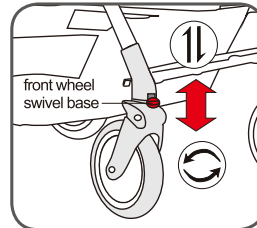

### ⚠ ATTENTION:

**Before moving backwards the swivel wheels must be released! Failure to follow the rules of swivel wheel operation may cause mechanical damage to the wheel system, which will not be covered by the guarantee.**

### DISMANTLING THE FRONT WHEELS

Pull the quick-remove button of the front wheel and take out the wheel.

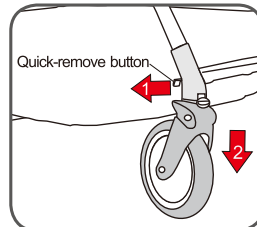

Assemble the rear wheel parts as show.

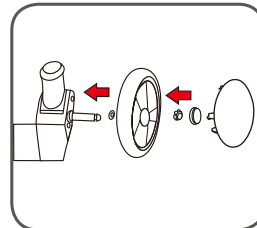

### ASSEMBLING BACK WHEEL HOLDING ASSEMBLY

Lift up the stroller frame with one hand and hold the back wheel assembly with the other hand, and put the back wheel foot tube into the plastic of back wheel holding assembly as the arrow shows until hearing a "click" indicating the assembling completed.

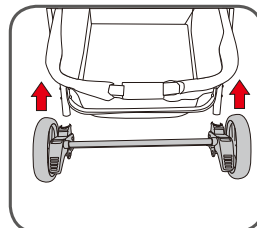

### THE REAR WHEEL BRAKING

Step down the braking board in the rear wheel to apply the brake (the stroller is hard to move forward or backward) and lift the linkbrake up to release (the stroller is free to move forward or backward).

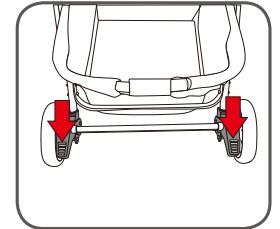

### DISMANTLING THE REAR WHEELS

Press the quick-remove button of the rear wheel and take out the wheel.

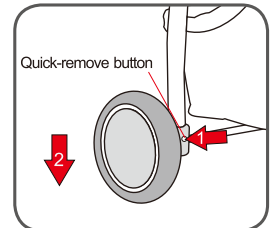

### ATTACHING FRONT BUMPER

Insert front bumper into the side bumper and make sure that front bumper closely locked on the stroller frame and cannot be pulled out. This indicates the assembling is complete.

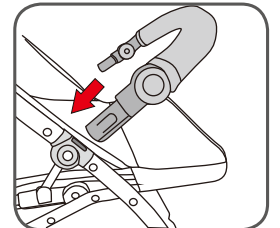

### DISMANTLING THE FRONT BUMPER

Press the removing button of the front bumper and take it out.

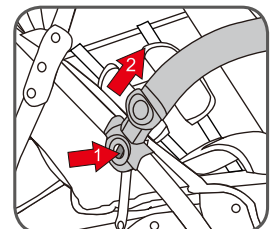

### THE FRONT BUMPER ADJUSTMENT

The front bumper can be adjusted by the adjusting button.

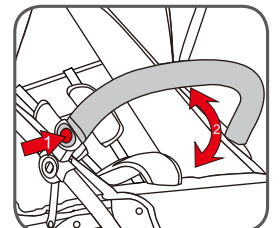

### CANOPY ADJUSTMENT

The canopy can be closed and opened by adjusting the canopy tube.



### PEDAL ADJUSTMENT

Pull the adjusting button, the pedal can be adjusted.

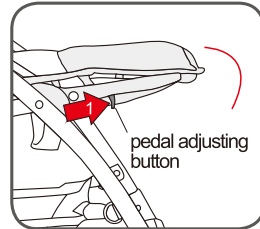

### BACKREST ADJUSTMENT

Press the backrest adjuster and pull it down, then it can adjust until flat position; Hold the backrest adjusting belt by one hand, and pull up the backrest adjuster by the other hand, then it can adjust until sitting position.

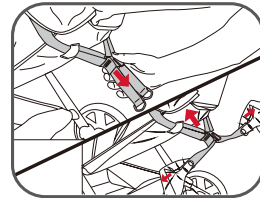

### OPEN 5-POINTS SAFETY BELT

Press down the left of the open button, the left of the buckle prongs are popped; press down the right of the open button, the right of the buckle prongs are popped, then plugs in 5-points safety belt are popped out automatically.

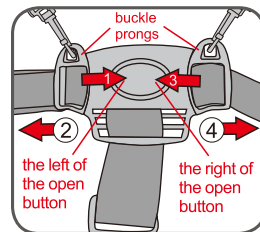

### BUCKLE 5-POINTS SAFETY BELT

Insert the plugs in socket till hearing a sound "kacha", 5-points safety belt is buttoned up.

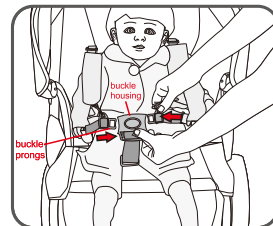

### ADJUST 5-POINTS SAFETY BELT

Move 5pcs of adjustable clip in safety belt, the length of safety belt is adjustable.

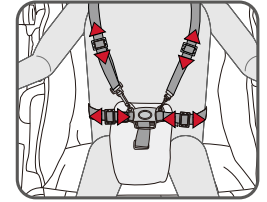

### SHOULDER BELT HEIGHT ADJUSTMENT

As shown, remove the shoulder belts from the button-hole, adjust it according to the child's height, figure, put the shoulder belt through the button-hole of the mattress, smooth it before use.

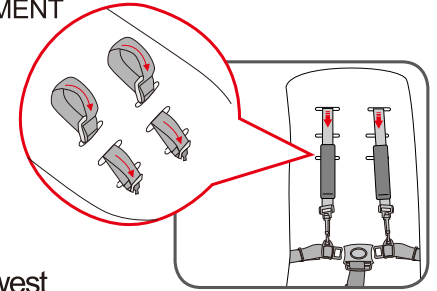

### WARNING!

Must use the button-hole in lowest position for the child under 6 months.

### FOLDING THE FRAME

Pull the red button (second folding lock) in the right hand (figA); Pull up the folding belt as arrow show, then the stroller can be folded (figB); when hear a "click", the folding hook is locked in the frame (figC).

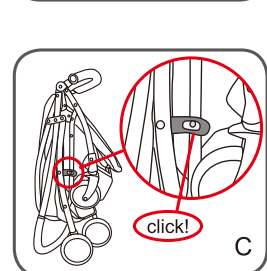
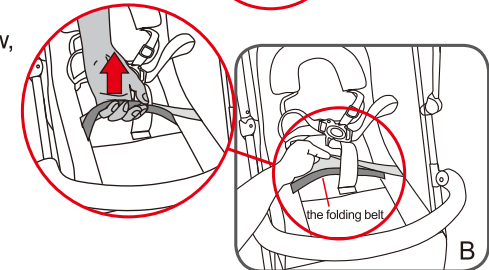
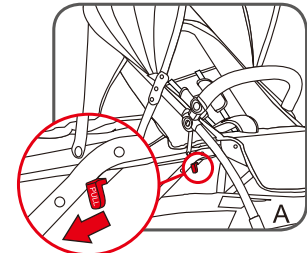

### WARNING!

Before folding the frame, Don't lock the front wheel swivel! If you lock the front wheel swivel, the frame can't be folded.

### FIX THE FOOT COVER

Wind the top of the foot cover around the rear leg tube, and then put the sticker on the bottom of the rain-cover on the front tube.

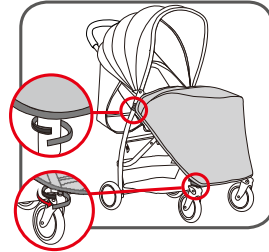

### FIX THE MOSQUITO NET

Make the top part of mosquito net cover the canopy, then make the bottom cover the rear leg tube. After that, put the sticker on the bottom of the mosquito net around the front tube.

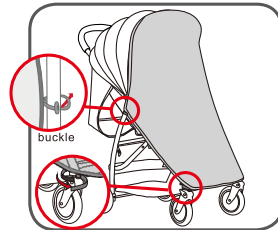

### INSTALLING RAIN COVER

Keep the rain-cover around the stroller from the bottom to the top and to the back. Put the sticker on the bottom of the rain-cover around the front tube; and then, put the sticker on the back of the rain-cover.

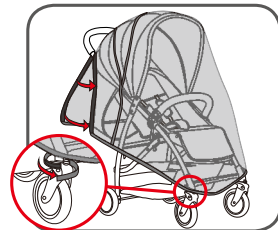

## HOW TO CARE FOR YOUR STROLLER

### MAINTENANCE

- This stroller requires regular maintenance by the user.
- Regular lubrication of moving parts will extend the life of your stroller and make opening and folding easier.
- Check your stroller regularly. If any parts, like bolts, screws, fabric pieces or stitching are found to be loose, broken or damaged, always repair or replace them.
- Regularly inspect the locking devices, brakes, wheels, harness assembly, catches, seat adjusters, joints and fixings to ensure they are secured and in full working order. These should be free to move at all times.
- Brakes, wheels and tyres are subject to wear and should be replaced if necessary.
- Do not leave the stroller in sunlight for prolonged periods - some fabrics may fade.
- Your stroller should be serviced and reconditioned before using it for a second baby, or within 18 months, whichever is sooner.
- Where damage or dysfunction occurs, stop using the stroller.

### CLEANING

- Plastic and metal parts may be sponged clean with warm water and a mild detergent.
- Never clean with abrasive, ammonia based, bleach based or spirit type cleaners.
- Storing a damp stroller will encourage mildew to form.
- Dry thoroughly before storing.
- After exposure to damp conditions, dry off with a soft cloth, open fully and dry in the air.

# WARRANTY REGISTRATION CARD

To register for your 12 month warranty, complete this warranty card and return it within 7 days of purchase to [warranty@baciuzzi.com](mailto:warranty@baciuzzi.com)

Name \_\_\_\_\_

Address \_\_\_\_\_

Postcode \_\_\_\_\_

Phone \_\_\_\_\_

Email \_\_\_\_\_

Product Name/Model No.\* \_\_\_\_\_

Colour \_\_\_\_\_ Serial No.\* \_\_\_\_\_

Place of Purchase \_\_\_\_\_

Date of Purchase\* \_\_\_\_\_

Stamp, date and signature of the seller shop\*

The data is necessary; without any of them the warranty will NOT be valid.

China Agency:  
Unitron Enterprises Zhuhai Co., Ltd  
Add: Rm. B305, East-Asia Building, Jiuzhou Road,  
Jida Zhuhai, Guangdong, China  
Tel: +86-756-3870111  
Fax: +86-756-3870122  
E-mail: [b3c@baciuzzi.com](mailto:b3c@baciuzzi.com)  
[Http://www.baciuzzi.com](http://www.baciuzzi.com)

# WARRANTY

## Warranty Terms and Conditions

Subject to the following, Baciuzzi warrants that:

1. This product complies with all safety requirements.
2. This product is free from defects in workmanship and material under normal use for 12 months from the date of purchase, as recorded on the invoice (warranty period'). In the event of a defect during the warranty period, you are requested to contact your retailer or place of purchase.

**Subject to the following, the warranty does not apply in the following circumstances:**

1. Where the product is not supplied to Baciuzzi Brands or an authorised repair agent with the original sales receipt.
2. The defect is the result of use of the product not in accordance with the instruction given in any manual or instructions supplied with this product (including, but not limited to; where the maximum weight allowance specified for the product has been exceeded), or maintenance that is contrary to the instructions given in any manual or instructions supplied with this products.
3. Damage caused directly or indirectly by repairs that have been carried out by you and any third party (excluding authorised repair agents).
4. Where the defect is discolouration, damage to the fabric or watermarks due to washing that has not been in accordance with the instructions given in any manual or instructions.
5. The defect is as a result of accidental damage.
6. The defect is as a result of damage caused to the product by negligent transportation of the product other than by Baciuzzi Brands.
7. Where the product has been damaged through the use of accessories that have not been approved for use by Baciuzzi brands in relation to the product.

The warranty is non-transferable and may only be invoked by the first owner.

None of the above is intended nor should be interpreted as restricting, modifying, excluding or having the effect of restricting, modifying or excluding the rights of the consumer in relation to the supply of the product to the consumer.





## 感谢寄语

恭喜您为自己的宝宝做出了明智的决定，选择这款独一无二的BX婴儿手推车。

这款车集中体现了Baciuzzi（帕琦）一直以来秉持的“人性化科技+高端时尚”的设计理念。请在使用手推车前仔细阅读该手册，并妥善保管，以备随时查阅。

如您需要了解更多的信息，请随时登陆Baciuzzi(帕琦)的官方网站：[www.baciuzzi.com](http://www.baciuzzi.com)，我们将竭力为您提供最好的服务和保障。

最后，感谢您对Baciuzzi(帕琦)品牌的支持！

## 目录：

产品介绍及结构示意图	19-20
产品安装及使用说明	21-26
车台维护与保养	27
保修条款及保修卡	28-29

## 使用注意事项

提醒使用者及监护人在使用推车前请仔细阅读本产品说明并且请妥善保管供以后参照使用。如果不遵循说明书使用可能会影响儿童的安全。

- 本儿童推车的座位靠背调至最后位置时适合0-36个月儿童使用，其余靠背角度不适合于6个月以下的儿童使用！
- 本儿童推车最大承载重量为15公斤！
- 为了您孩子的安全，一定系好安全带，且大人不要离开孩子！
- 请按正确的使用方法使用童车，避免任何危险情况。
- 切记小孩没人照顾可能产生危险！
- 儿童乘坐时必须使用安全带！
- 使用推车前确保所有锁定装置都已处于锁定状态！
- 无论任何时候停下童车，请锁紧童车的刹车装置！
- 禁止使用非生产商提供的附件！
- 在手把上放置任何负载会影响车辆的稳定性。
- 切勿近火！
- 座位内不应增加厚度超过10mm的棉垫。
- 本童车只能供一个儿童使用！
- 在楼梯或电梯上不要使用童车！
- 不要奔跑或穿溜冰鞋推动本童车！
- 孩子仍坐在童车里时严禁松开安全锁装置防止误收合车辆！
- 孩子仍坐在童车里时严禁一手抓手把、一手抓(餐盘)扶手、将童车提起！
- 如发生零部件损坏或性能出现问题，应立即停止使用！
- 储物篮的最大承载重量不能超过3公斤(6.61磅)！
- 奶瓶袋的最大承载重量不能超过0.2公斤(0.441磅)！
- 拆开包装后请及时将包装袋收好，避免幼儿玩耍而引起窒息！

- 本说明书内全部图片仅供参考，所有车台配件、附件均以实物配置为准。

## 禁用示意图



禁止不用安全带



禁止大人离开小孩



禁止孩子在座位站立



禁止抓前扶手提起童车



禁止推车下楼梯

## 产品特色

- 产品名称：座卧两用四轮儿童推车
- 产品型号：BX
- 产品标准编号：EN1888:2012 / GB14748-2006
- 避震车轮  
有效吸收颠簸路面上不愉快的震动,宝宝乘坐更舒适
- 透气型环保布料  
散热透气利于宝宝体温调节,使宝宝身体随时保持清爽、健康
- 无极调节靠背设计:  
既能完全平躺,提供最自然的睡眠姿势;又能完全坐立,提供最舒适的座乘感觉
- 后轮一踩双刹,刹车控制更方便
- 五点式安全扣,宝宝乘坐更安全
- 扶手可拆卸,方便宝宝上下车
- 脚踏可调节垂直或水平,宝宝乘坐更舒适
- 单手收车、配有二道收车安全锁
- 收车可站立,避免弄脏车
- 超大储物篮,方便妈妈外出携带宝宝物品
- 展开尺寸:98.1x81.6x47CM
- 包装尺寸:41.5X26X76.5CM
- 净重:4.5kg(不包含配件)

## 结构示意图

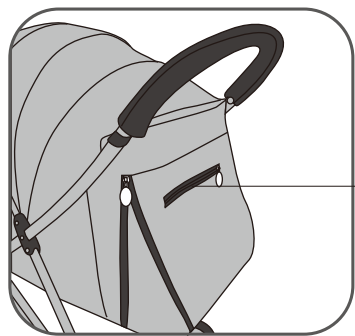
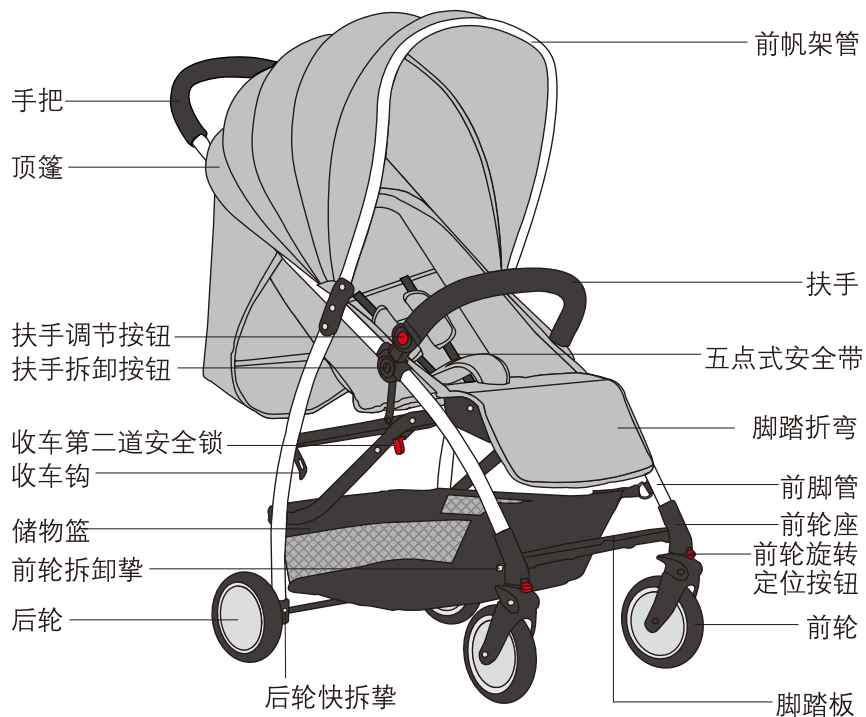

奶瓶袋

## 产品安装及使用说明

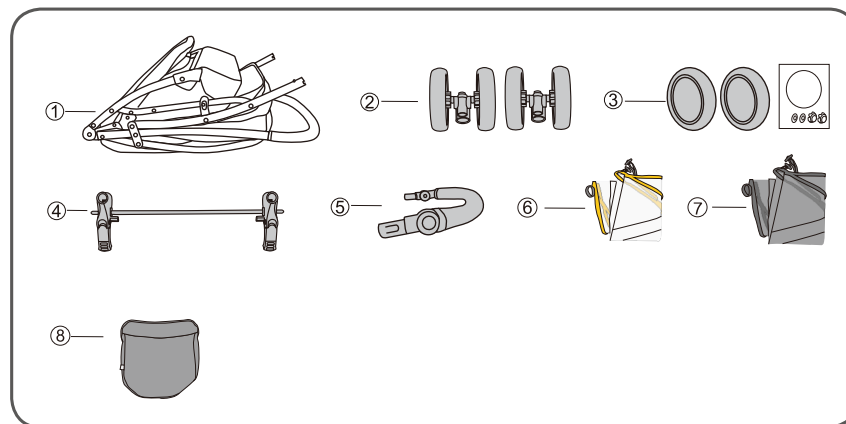

- 开箱取出配件:
- ① 一个车主体
  - ② 两组前轮
  - ③ 两个后轮及后轮配件
  - ④ 一个后轮座组
  - ⑤ 一个扶手
  - ⑥ 一个雨罩
  - ⑦ 一个蚊帐
  - ⑧ 一个脚罩

### 打开车架

打开包装袋，取出车架，(如图A所示)用手扳开“收车钩”，使其脱离收车固定粒；接着手把同时往上提，展开车架；当手把管与前脚管成一直线，同时听到“咔嚓”声响，车架即打开完成，(如图B所示)。

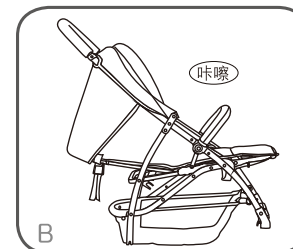
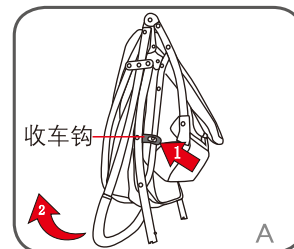

### 安装前轮

将前轮用力推进前轮座，当听到“咔嚓”声响，并且前轮锁紧在前轮座上无法拉出，前轮即安装到位。

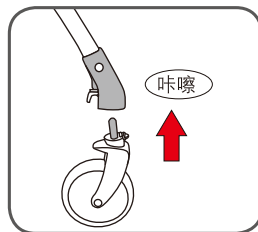

### 前轮转向定位调节

对准前轮定位孔向上推前轮定位按钮，前轮定向（车台直线推行），下按前轮旋转定位按钮，前轮可旋转（车台可随意转弯）。

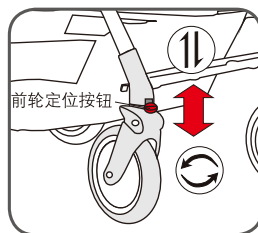

### 拆卸前轮

按箭头方向向外拉前轮快拆挚，一手往下拉前轮即可拆卸。

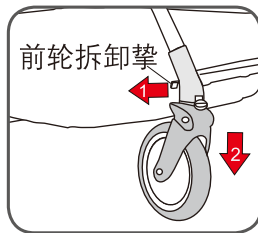

### 安装后轮及后轮配件

按右图所示的顺序,将后轮及后轮配件安装到后轮座上。

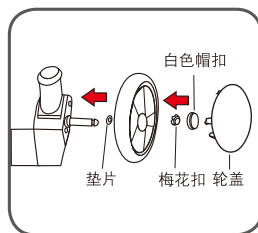

### 安装后轮组

将后轮组对准后脚管用力推进，当听到“咔嚓”声响，并且后轮组锁紧在后脚管上无法拉出，后轮即安装到位。

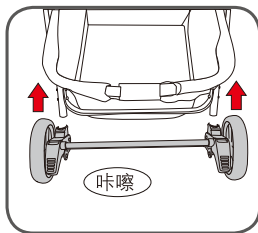

### 后轮刹车操作

踩下任意一边的“后轮刹车杆”，后轮刹车（车台不容易往前后移动），踢上“后轮刹车杆”，后轮刹车松开（车台可随意推行）。

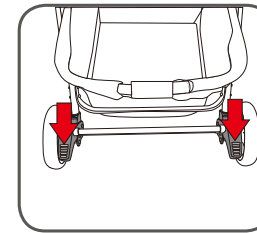

### 拆卸后轮组

按进后轮座上的后轮组快拆挚（白色五金），一手将后轮组从后脚管拉出来。

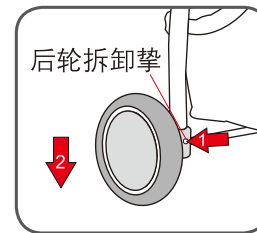

### 安装前扶手

扶手安装需先分清左右方向（扶手插头有凸台面的边朝下，这样安装时扶手的左右方向才是正确的），接着将扶手对准扶手座导向槽插入，用力把扶手上的插头插到底，并且扶手锁紧在座位上无法拉出，扶手即安装到位。

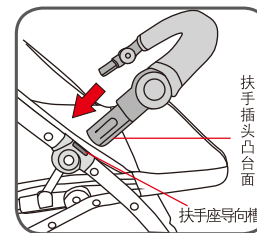

### 拆卸前扶手

按进扶手两侧的“扶手拆卸按钮”，可将扶手往外拉出。

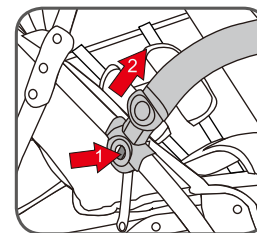

### 调节前扶手

按进扶手两侧的“扶手调节按钮”，可调节扶手的高度。

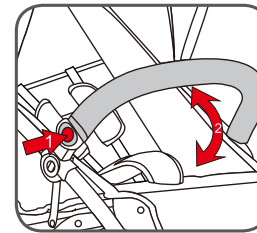

### 调节顶篷

手拉前帆架管，可以调节顶篷打开的幅度。



### 调节脚踏折弯

双手同时拉脚踏折弯底部两边的脚踏折弯调节按钮，可以调节脚踏垂直或水平的角度。

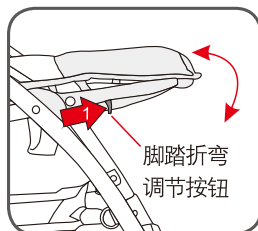

### 靠背调节

用手勾住调节勾再往下拉,可以任意调节靠背展开角度;手拿住靠背调节塑胶,拉紧靠背调节带,可收起靠背。

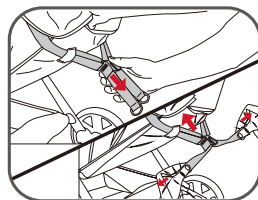

### 打开五点式安全带

按如图箭头1方向按下左边插头的打开按钮，五点式安全带左边的插头即可自动弹开；按如图箭头2方向按下右边插头的打开按钮，五点式安全带右边的插头即可自动弹开。

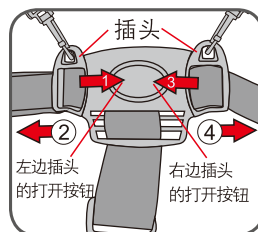

### 扣合五点式安全带

将插头插入插座，直到听到“咔嚓”声五点式安全带即扣好。

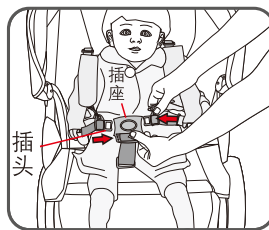

### 调节五点式安全带

移动安全带上的五个日型扣，可调节各条安全带的长度。

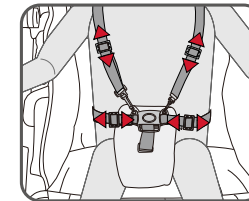

### 肩带高度调节

如图，将两侧肩带从对应的锁孔抽出，根据孩子身高、体形需求，调节至合适高度，穿入棉垫上的锁孔，抚平理顺即可使用。

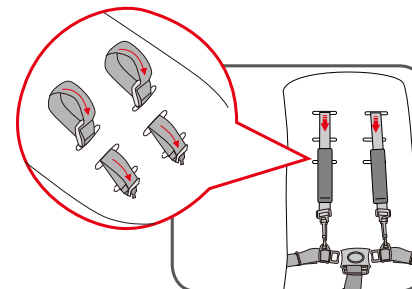

**注意：**六个月以下的儿童请务必使用最低位置的锁孔!

### 收合车台

往外拉位于面对车台方向左侧面的红色收车二道安全锁按钮（图A）；接着向上提起位于座位上的收车带即可开始收合车台（图B）；将车架继续压缩，直到听到“咔嚓”声响，收车钩自动锁在收车钩固定粒上，收车即完成（图C）。

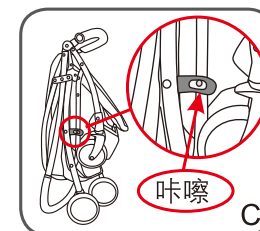
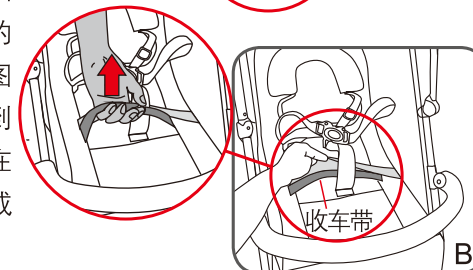
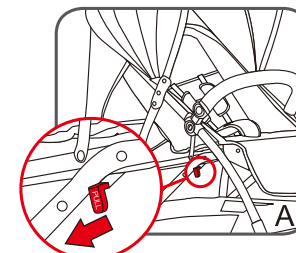

**注意：**收车前，请务必将前轮转向定位座调节成可旋转状态，否则,收车时收车钩将无法固定在车架上!

## 安装脚罩

先将脚罩按如图罩在车架上,再将脚罩上部的魔术贴绕过后脚管粘好。脚罩底部的魔术贴绕过前轮上座粘好即安装好。

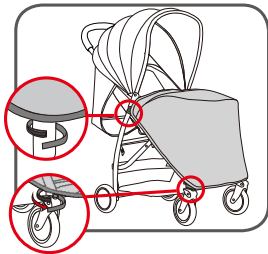

## 安装蚊帐

按如图所示先将蚊帐上部罩住顶篷,下端罩住脚踏板,再将蚊帐左右两边的橄榄扣绕过后脚管扣好,蚊帐下端的魔术贴绕过前轮上座粘好即安装好。

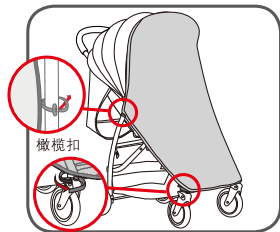

## 安装雨罩

将雨罩按如图所示罩住车架,雨罩的后片穿过手把与顶篷之间的空隙,粘好雨罩后片与侧面两边的魔术贴;接着将雨罩下端左右两边的魔术贴绕过前轮上座粘好即安装好。

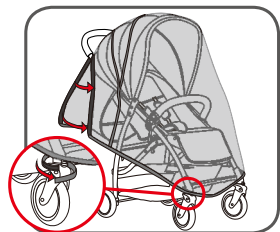

雨罩安装好的示意图。

## 车台维护与保养

### 维护

- 定期给活动部件加润滑油可以延长本童车的使用寿命,而且可以更容易地打开和折叠本童车。
- 请定期检查本童车,如果发现诸如螺栓、螺丝、织物部件或缝合部件松动或损坏,请修理或更换。
- 锁紧装置、刹车、轮子、安全带、座位调节器、固定装置应该总是活动自如的,请定期检查以确保它们的安全可靠和工作正常。
- 刹车系统、轮子都是易磨损部件,损坏时要及时更换。
- 不要将本童车长时间地置于阳光的照射下,这样会使织物部件褪色。
- 将本童车拿给另外的儿童使用时、或在使用18个月的期限内应对童车进行保养维护。
- 不要把本童车存放在潮湿的地方,否则会使童车发霉变形。
- 存放本童车前请将童车进行彻底干燥。

### 童车的清洗和保养

- 本童车的塑料和金属部件要用海绵吸取温水和软性清洁剂进行清洗。
- 决不要用擦洗剂、氨水清洗剂、漂白清洁剂或含酒精的清洁剂清洗本童车车架、座布、顶篷。
- 如本童车置于潮湿的地方后,请用软布擦干,并完全打开童车置于通风处晾干。

# 保修书登记卡

要登记本产品12个月的保修期限,请填写本保修卡并在购买产品后7天内发送到warranty@baciuzzi.com

姓名 \_\_\_\_\_

地址 \_\_\_\_\_

邮政编码 \_\_\_\_\_

电话 \_\_\_\_\_

电子邮件 \_\_\_\_\_

产品名称/型号 \*

颜色 \_\_\_\_\_ 系列编号 \*

购买地 \_\_\_\_\_

购买日期 \*

销售商店印章、日期和签名\*

\* 必须填写以上资料, 如果以上内容空白, 则本保修卡无效。

**BACIUZZI 帕琦**

中国总代理: 珠海优力创工贸有限公司

地址: 广东珠海市吉大九洲大道东亚大厦B305  
制造商: 珠海阳光儿童用品有限公司  
制造商地址: 广东省珠海市金湾区联港工业区  
红灯片区永安路11号

电话: 0086756-3870111  
传真: 0086756-3870122  
E-mail: b3c@baciuzzi.com / baciuzzi@baciuzzi.com  
网址: www.baciuzzi.com

# 保修书

## 保修书条款

1. 本产品满足所有的安全要求。
2. 本产品的制作工艺和材料均无瑕疵, 可以确保本产品从购买发票记录之日起正常使用12个月(保修期)。如果在保修期内本产品出现问题, 客户可以联系你的产品零售商或产品销售地区经销商。
3. 消费者对产品或者保修服务不满意的, 可打本公司投诉电话: 0086756-3870111 全国统一服务热线: 4000756122

## 本保修卡不适合以下情形:

1. 本产品在接受Baciuzzi品牌商或其授权的维修代理商(维修)时没有能提供原始的销售凭据。
2. 使用本产品时出现问题的原因是没有按照本产品的使用手册或使用说明(包括但不限于:超过了本产品的最大负载)来使用本产品, 或在对本产品进行维护时没有遵循本产品的使用手册或使用说明。
3. 由客户或任何第三方(不包括授权的维修商)进行维修而直接或间接导致的损坏。
4. 本产品织物或水印的脱色或损坏的原因是没有按照产品的使用手册或使用说明进行洗涤、或本产品被暴露于雨水中或阳光下。
5. 由事故而导致的本产品的损坏。
6. 由非Baciuzzi品牌商的草率运输而导致的本产品的损坏。
7. 由于使用没有获得Baciuzzi品牌商认可的零部件而导致的本产品的损坏。

本保修卡是不可转让的, 只对本产品的第一购买人有效。

就提供本产品给客户的行为来说, 以上条款不可也不应该被解释为制约、修订或排斥客户的权利、或对制约、修订或排斥客户的权利具有影响力。

